

Osiris / Trident / Poseidon Android Manual

3/3/2019

Revision: 1

This manual outlines operation of the Osiris App for Android phones

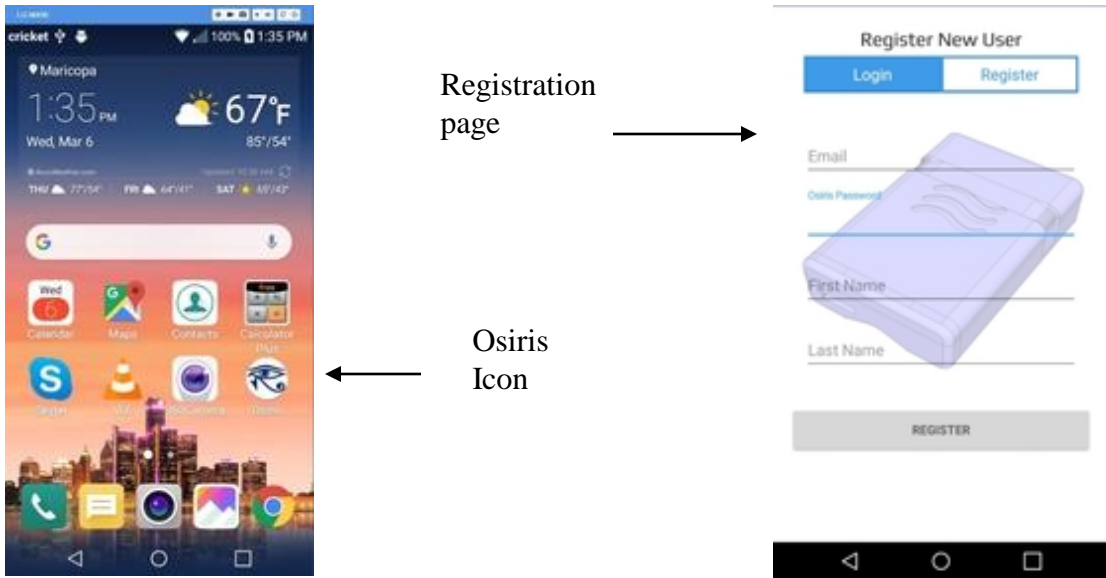

The first time you open this App, you will be asked to register with the AZ APPS server as a new user. Following your registration, you will be asked to register your unit (Osiris, Trident or Poseidon) and to connect it to the Internet through your home network. All three products operate via WiFi (wireless internet), therefore your router need to have WiFi enabled.

Please refer to the [How to Setup Osiris 2, Trident & Poseidon](http://www.myazapps.com) page on the www.myazapps.com website. There is also a PDF that will take you through the process, step by step.

Once your unit is online, you can use the free Osiris App to monitor your water use, detect water leaks, conserve water, and protect your home from water damage.

Status Page

Status Page displays all relevant information about your unit at a single glance.

Your unit is not reporting to the AZ APPS server

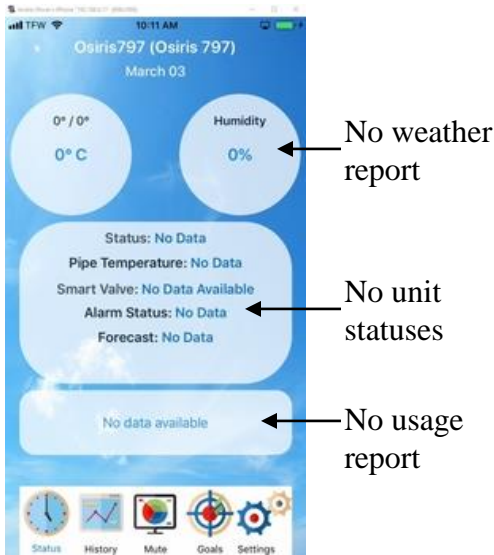

- A unit may not report in because
- 1) You entered an incorrect WiFi name & password
 - 2) Your unit is out of range of your WiFi router
 - 3) Your WiFi network is not connected to the Internet

A correctly operating unit:



During Alarm:

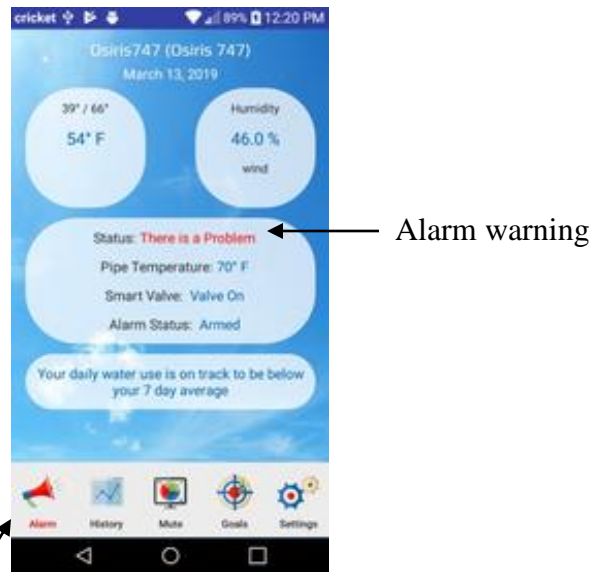

Alarm redirects you back to Alarm page

Alarm Page

Alarm Page displays all relevant information concerning a water leak alarm or a pipe freeze alarm

Annotations for the top screenshot:

- Navigates to Call a Plumber page (points to the phone icon)
- Touch to let your contacts know you are getting it or not (points to the 'I Can't Get It' button)
- Cancel alarm (points to the 'Cancel Alert' button)
- Navigates to Trident page to turn off water (points to the Trident icon)
- Your emergency contacts (points to the contact list)
- Get more info navigates to Alarm Information page (points to the 'More Info' button)

Annotations for the bottom screenshot:

- Recent events causing the alarm (points to the flow graph)
- Suggested ways to remedy the situation (points to the remediation text box)
- Go to Status Page (points to the 'Return to Status Page' button)
- Return to Alarm page (points to the top-left corner)

History Page – Daily Water Use

Select Day, Week, Month or Year

Change the day

Select Bar graph or Line graph

Water use
Osiris = minutes per hour
Poseidon = liters per hour

No Alarms. If there had been an alarm, the Status Icon would be **RED**

Weather forecast

The screenshot shows a mobile app interface for 'Daily Water Use'. At the top, there are tabs for 'Day', 'Week', 'Month', and 'Year'. Below the tabs is a date selector showing '< Feb 09, 2019 >'. The main display area features a bar graph titled 'Current (Minutes)' with a y-axis from 0.0 to 40.0 and an x-axis with time slots: 12AM, 4AM, 8AM, 12PM, 4PM, and 8PM. Below the bar graph is a weather forecast section with three columns: 'Temperature High' (59°F), 'Temperature Low' (36°F), and 'Relative Humidity' (51%). At the bottom, there is a navigation bar with icons for 'Status', 'History', 'Mute', 'Goals', and 'Settings'.

History Page – Weekly/Monthly/Yearly Water Use

Select Current water use or Progress over past week, month or year

Change the week

Select Hi / Lo Temperature or Relative Humidity

Current
Last Week

The image shows two side-by-side screenshots of the 'Weekly Water Use' app interface. Both screenshots have the same top navigation and date selector. The left screenshot shows a bar graph titled 'Current (Minutes)' with a y-axis from 0 to 180 and an x-axis with dates: Sun Feb 03, Wed Feb 06, and Sat Feb 09. Below the bar graph is a line graph titled 'Local Temperature (°F)' with a y-axis from 30.0 to 60.0. The right screenshot shows a bar graph titled 'Progress (Minutes)' with a y-axis from 0 to 250 and the same x-axis. Below the bar graph is a line graph titled 'Relative Humidity (%)' with a y-axis from 40.0 to 80.0. Both screenshots have the same bottom navigation bar.

Mute Alarms Page



This page is for unscheduled extended water use. Use it to turn alarms off when filling a swimming pool, deep watering a tree or doing plumbing repairs.

Select minutes, hours, or days

Set Water Conservation Goals

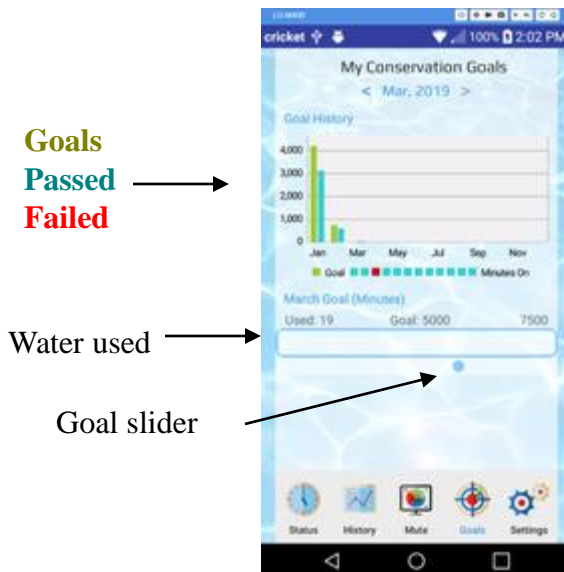

Set a monthly goal to conserve water and save money. Go back to previous months to get personal feedback on your water habits.

Find out if you're using more water than normal in the morning, at night, or on weekends.

The new value is uploaded to the server after the slider is released for a few seconds

Settings – Trident Smart Valve



This page controls the Trident Smart Valve.

You must be looking at a Trident, or an Osiris or Poseidon that is paired with a Trident.

Dialog box Confirm your change

Settings – Call a Plumber

This page lists plumbers that have registered with AZ APPS.

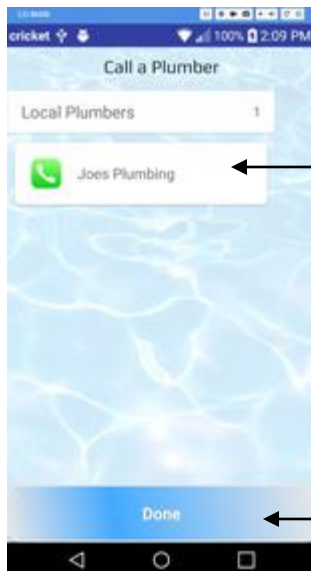

Touch, hold, and release the icon to dial a plumber

Exit this page

Unit Settings – Manage Contacts

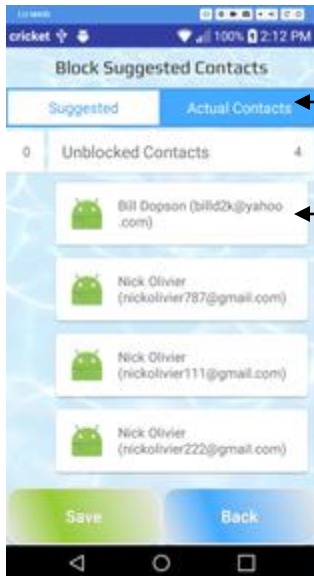

Touch Suggested or Actual

Hold your finger on a person to select them, then drag them into the column where you want them

This page manages the contacts that will receive water data and/or Alarms.

1. Suggested Contacts are people who entered you into their Osiris contacts list
 - a. You can block or unblock them
2. Actual Contacts
 - a. You can move suggested contacts into actual contacts
 - b. You can delete actual contacts by moving the contact to the right into the delete contacts list

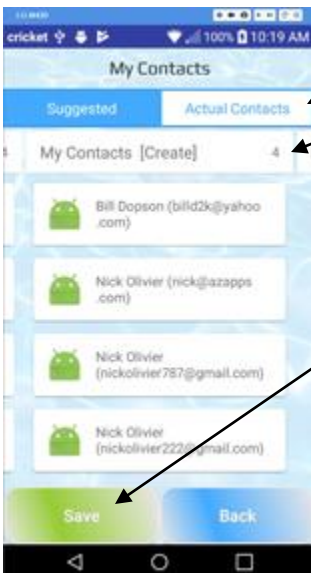

To create new contacts:

1. Touch Actual Contacts
2. Touch My Contacts (Create)
3. You will see a dialog box
4. Enter first name, last name & email, then Save
5. Touch Save

To delete contacts:

1. Hold contact to select
2. Drag contact to the Delete Contacts list
3. Release contact, and they will disappear
4. Touch Save

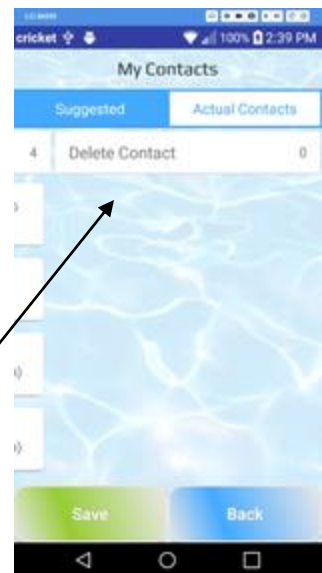

Unit Settings – Manage Units

This page selects the default unit. This unit is automatically selected when you start the App

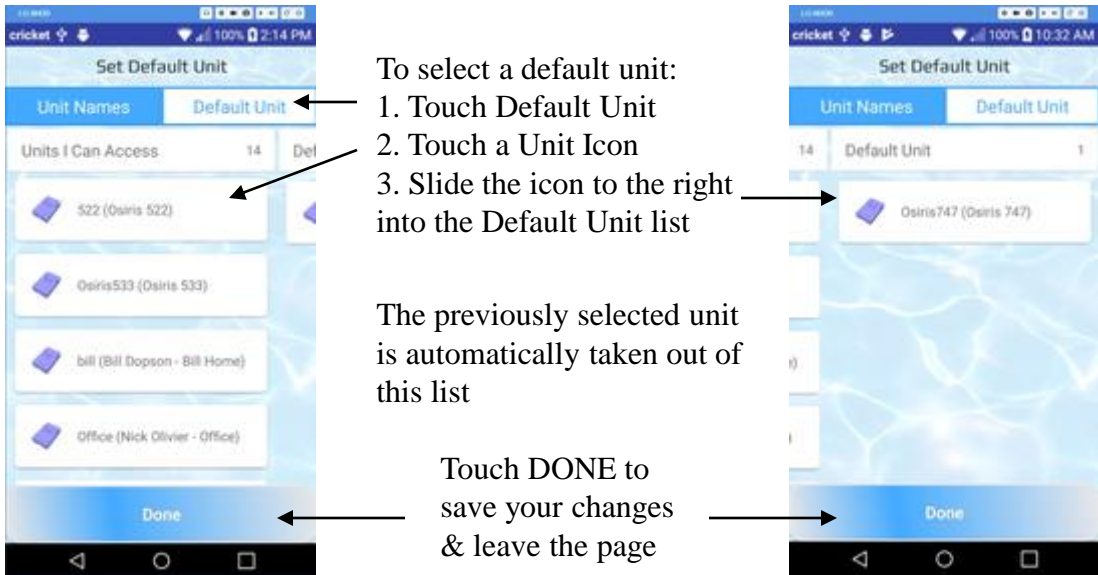

Unit Settings – Assign Tridents to Units

This page pairs Trident water valves with Osiris and Poseidons. You can then control the Trident valve by selecting the Osiris or Poseidon and navigating to the Trident Page

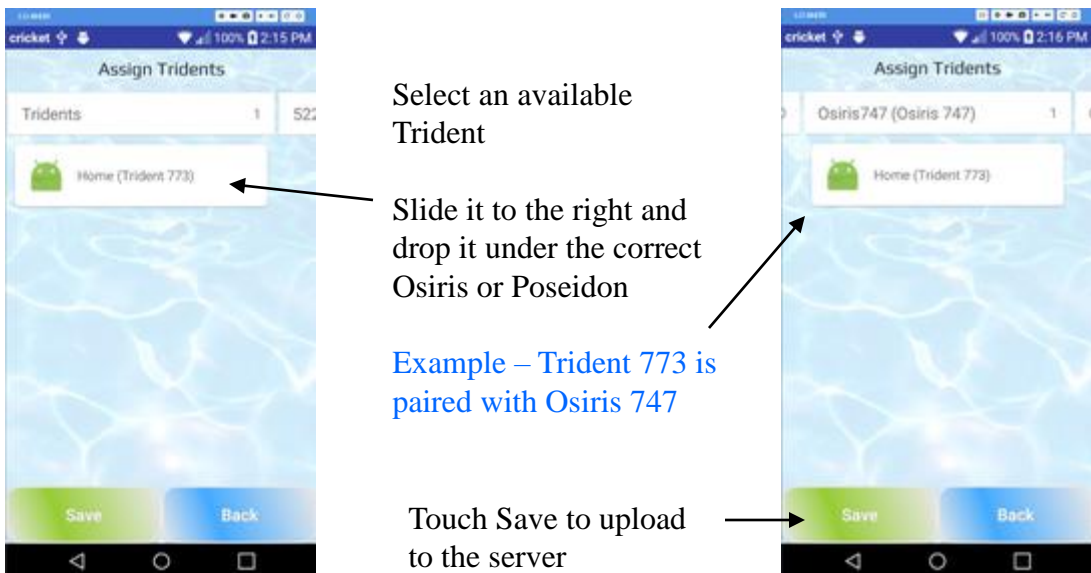

Unit Settings – Assign Contacts to Units

You can assign many contacts to one unit, with different access levels

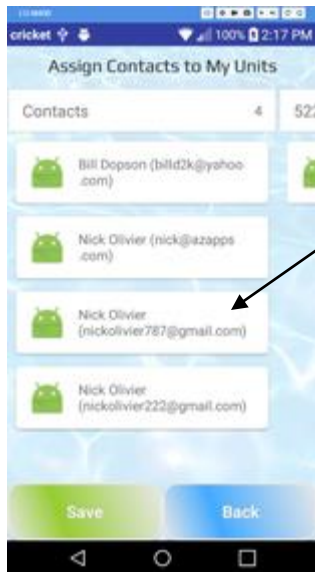

Select an available contact icon

Slide it to the right and drop it in the correct Osiris column

You can have up to 6 contacts per unit

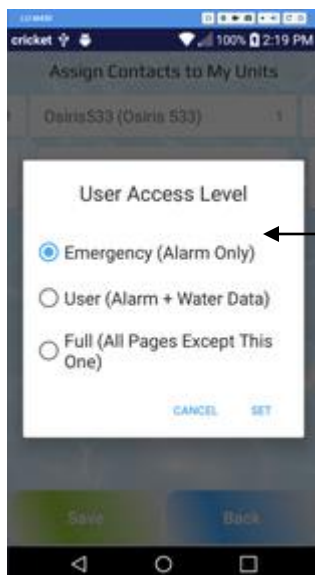

To change a user's access level:

1. touch the user to pick them up
2. drop them in place
3. a dialog box appears
4. set their level of access

Touch SAVE to upload to the server



Unit Settings – View Another Unit



You can view another unit without changing your default unit

Touch a unit icon

Slide it to the right and drop it in Selected Unit list

Touch DONE
Your unit will stay selected until you exit the App or select another unit



Unit Settings – Register a New Unit

Register as the owner of your Osiris, Trident, or Poseidon

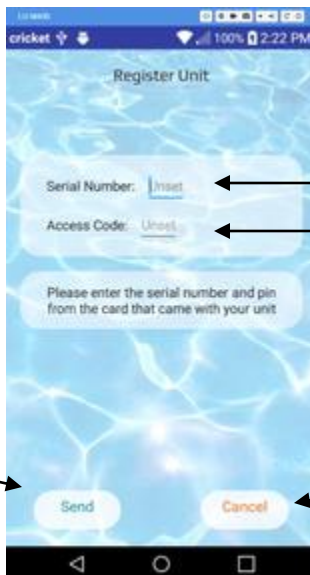

Enter the unit Serial Number and Access Code from the card you received with the unit

Touch SEND to upload the data to the server

Leave this page

Unit Settings – Connect Unit to My WiFi

This page sends your home WiFi network Name and Password to your unit.
Your unit then connects to your home WiFi network and accesses the Internet.

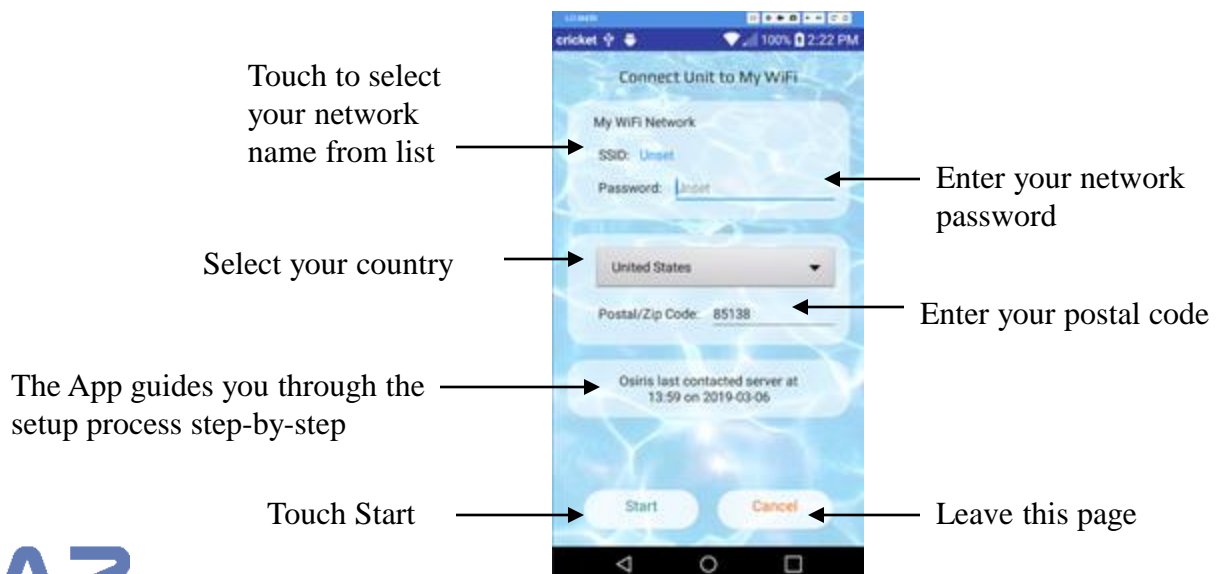

Unit Settings – View Diagnostics

This page displays data that your unit uploaded to the server today. It also tells you when your unit last connected to the server.

Your unit did not connect to the server today



No Data

No recent server contact

Your unit is connected

Raw data measured (Osiris or Poseidon only)

Last server upload & other relevant cal data

Leave this page

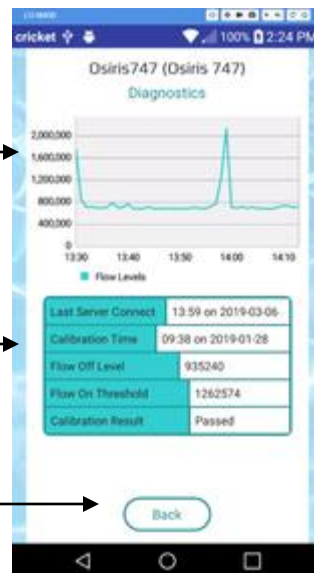

Unit Settings – Setup Cloud APIs

This page sets up your access to the free AZ APPS APIs. These APIs are used to link your unit with 3rd party Smart Hubs, such as Alexa, Google Home, Smart Things, or private servers such as Raspberry PI, Arduino, etc...

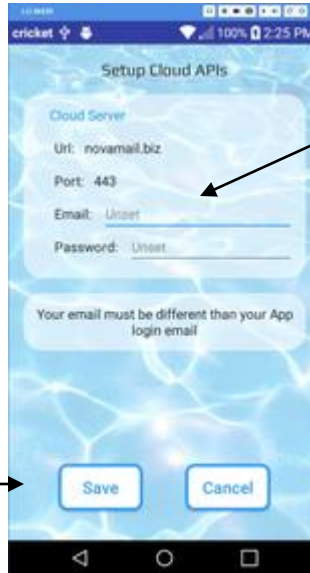

Choose a different email (not the one use to login to the App)

Choose a password

Touch Save to upload your data to the AZ APPS server

Unit Settings – Set Unit Alarms

Customize Osiris settings to suit your needs

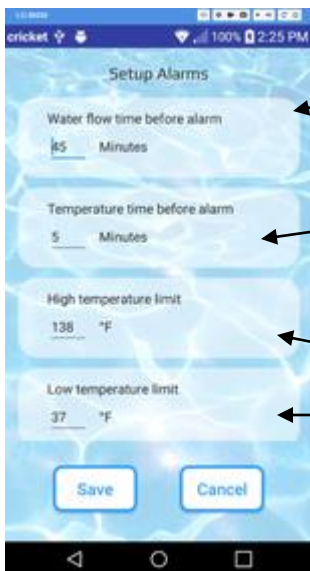

Water flow time before alarm

Hot/cold pipe time before alarm

High and low pipe temperature limits

Automatic water shutoff in case of an alarm (requires Trident Valve)

Fahrenheit / Celsius

Sensitivity adjust (Osiris only)

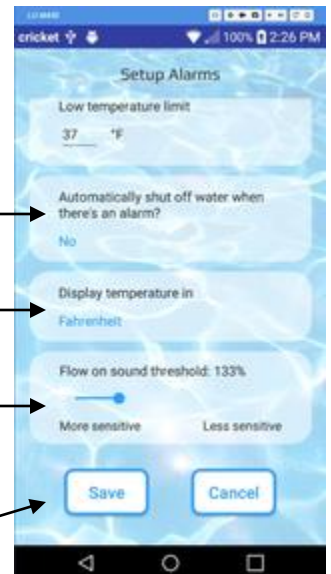

Touch Save to upload changes to the server

Unit Settings – Set Alarm Exceptions

Flow alarms can be disabled for regular flow events like yard sprinklers

Select day of week

Enter Start & Stop times

Four independently programmable zones

Enable or disable a zone without deleting its settings

Touch Save to upload data to the server

Leave this page

Unit Settings – Watch Help Videos

We have online videos to help you make the best use of your Osiris, Trident or Poseidon unit

Select the appropriate video and watch anytime, anywhere

Unit Settings – Logout

Touch logout and you have logged out of the App

If you do not log out, the Osiris App remembers you and you won't have to log back in the next time that you wish to use the App

Unit Settings – Calibrate Water Flow (Osiris 1 Only)

When we launched Osiris 1, we believed that it would be advantageous for users to manually calibrate Osiris. After much feedback from our customers, we realized that automatic calibration is better. Osiris 2, Trident, and Poseidon all auto-calibrate. You will not need this page.

After Q2,2019, Osiris 1 can be upgraded to also auto-calibrate. Online units will be upgraded over the air. Off-line units must be returned to AZ APPS for firmware update. Auto-calibration requires that the user download the latest version of the free Osiris App

